



# Engineering

*The Perfect Impression:* Taking your project from concept to production.

**OGIHARA AMERICA CORPORATION** provides a turnkey system solution to support our customers through the manufacturing process from feasibility through production. Our tooling and assembly engineers partner with customers in the design phase to shorten product development time and optimize the manufacturing process.

At Ogihara America, we understand the value of pressing into new technologies to provide our customer base with more efficient and cost effective options. Our engineering staff plays a key role in developing new technologies internally, or in concert with customers and other suppliers. The use of innovative equipment has been an important factor in our success.

## CAPABILITIES

### SIMULTANEOUS ENGINEERING



- Shortened product development time
- Prototype support
- Cross-functional team
- Evaluations and feasibility

### SIMULATION STUDIES

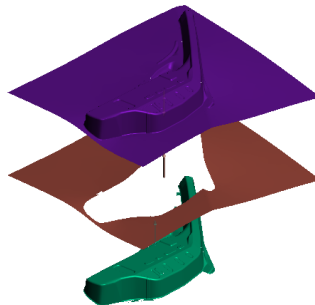

- CAD binder development
- Forming simulations
- Metal formability
- Virtual assembly
- Production simulations

### MANUFACTURING OPTIMIZATION

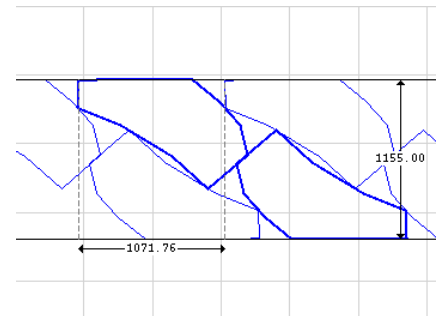

- Stamping die design/build
- Blank optimization
- Assembly tool and checking fixture design/build
- Production improvements (Kaizen & Lean Manufacturing)

### CAD SOFTWARE/SYSTEMS

AutoCAD, AutoForm, CATIA, IDEAS, ProE, SMIRT 8, TEBIS and Unigraphics

### TOTAL PROGRAM MANAGEMENT

Single Point of Contact  
Engineering Change Management  
Provide Tryout & Buyoff Production Panels

## OGIHARA AMERICA CORPORATION

1480 West McPherson Park Drive, Howell, MI 48843-3997

Phone: +1 517 548 4900 Fax: +1 517 548 6079 E-mail: Sales@Ogihara.com

[www.ogihara.com](http://www.ogihara.com)



# Engineering

*The Perfect Impression:* Taking your project from concept to production.

## PRODUCTION PLANT ASSISTS (OFFLOADS)

Ogihara America is fully equipped to attend to all your emergency production needs. For both domestic and international applications we are best in class for quick turn around and value. Our well seasoned team has over 100 years combined experience in plant assists requiring quick production turnaround. In these emergency cases we have had offloaded dies delivered and in production in less than 24 hours.

## INNOVATIONS

Ogihara America Corporation is continually pursuing the most effective production methods derived from the latest technology. Our goal, as a world class supplier of sheet metal tooling, stampings and modular sub-assemblies, is to meet or exceed our customers' expectations for cost, quality and delivery. The use of innovative equipment has been an important factor in our success.

### ENGINEERING

Providing a complete facility for TOTAL Program Management

### TOOLING

Providing FULL SERVICE tool manufacturing and maintenance capabilities

### STAMPING

Providing high QUALITY Class A panels and related subassembly

### ASSEMBLY

Providing MODULAR PRODUCTION with Just-In-Time delivery

### VIRTUAL ASSEMBLY

Using white-light scanning on individual components Ogihara America is able to conduct a virtual assembly prior to the actual assembling of panels during launch. This allows Ogihara America to find critical concerns early in the launch process.

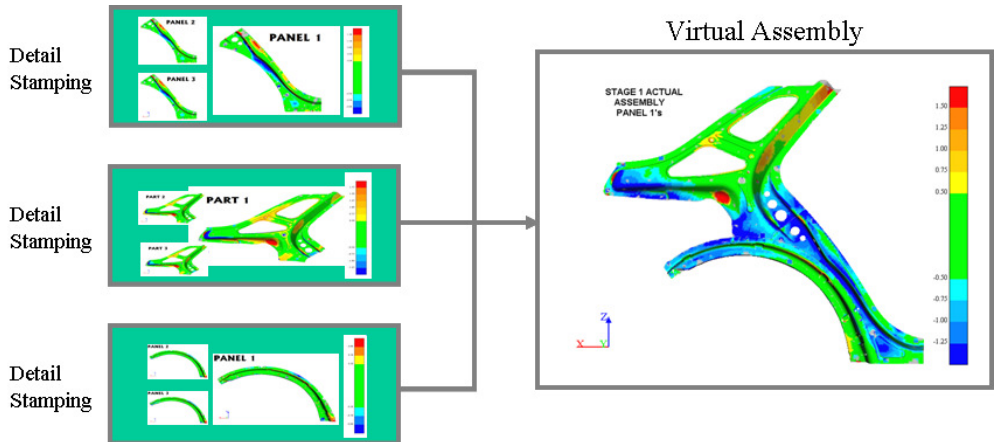

### Advantages

- Reduces number of change loops required for improvement
- More reaction time for improvements
- Reduces time spent on root cause analysis

## OGIHARA AMERICA CORPORATION

1480 West McPherson Park Drive, Howell, MI 48843-3997

Phone: +1 517 548 4900 Fax: +1 517 548 6079 E-mail: Sales@Ogihara.com

[www.ogihara.com](http://www.ogihara.com)